

## CST-06 - Key Operated Carbon Steel Valves in Packed Design (CGA V-9)

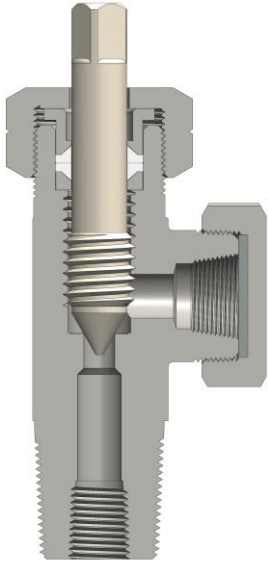

### Design Specifications

Minimum life	2000 cycles
Maximum design service pressure	3000 psig
Temperature range	-51 °F to +149 °F
Stem square	3/8 in
Minimum closing torque*	10 ft.lb
Failure torque in closing direction	>100 ft.lb
Packing nut installation torque	42 ft.lb
Flow coefficient (C <sub>v</sub> )	1.5
Lubricant	Krytox GPL 225
Pressure relief device (PRD)**	CG-2

\* Higher torques may be required to operate the valve in service  
(Maximum recommended 25 ft.lb)

### Available Outlet & Inlet Connections

Outlet Connection	Maximum Rated Outlet Pressure	Inlet Connection
CGA 240	500 psig	3/4-14 NGT (CL)-1 & 3/4-14 NGT (CL)-2
CGA 800		
CGA 845		
CGA 705	3000 psig	

### Material of Construction

Part	Material
Valve body	Low carbon steel
Stem	SS 316L
Packing X 2	PTFE
Packing gland, Packing nut, Packing collar & Seal nut **	Carbon steel
Gasket **	PA 66

\*\* Optional

For features & benefits, refer detailed catalogue



### Compliance & Certification

- Valves meet CGA V-9:2012, tested by BAM

